



DUOREST

User Guide



GOLD Series

Keep this manual handy for later reference.

Precautions

When using the product, basic safety precautions should always be followed to reduce the risk of injury including the following:

WARNING

- Do not let children climb on or play on the chair.
- Keep the packaging materials away from children. These materials are a potential source of danger, e.g. suffocation.

CAUTION

The gas lift must be replaced and repaired by a qualified professional only.

- Check that all the necessary parts are present before assembling the product. If you find any part missing or damaged, contact your dealer or our customer center.
- Dispose of all parts of the packaging according to environmental standards.
- Put gloves on before assembling the product.
- This chair is intended for indoor use only.
- Do not stand on the chair. When the chair moves or rotates, there is a risk of the user getting injured.
- Be careful not to get your toes caught on the casters.
- Do not let more than one person sit on the chair.
- Do not raise your feet onto a high place while sitting in the chair.
- Do not sit on the armrest.
- Do not put your hand into any moving part of the chair.
- Do not stay under the product. If the product falls, there is a risk of injury.
- If you are going to use the chair on the floor of which the material is susceptible to damage, lay a protective mat on the floor before use.
- Do not use the chair if any parts are damaged or worn. If required, return the complete product to your place of purchase for an inspection, repair or adjustment.
- Do not use accessories or attachments which are not provided by the manufacturer. It may cause product damage or personal injury.
- Do not use the chair near inflammables or fire devices.
- Do not expose the chair under direct sunlight for a long time.
- Do not use the product near a humidifier. If you use a humidifier near the product, calcareous matters dissolved in water may be ejected, causing white dust to accumulate on the product.
- Do not exceed the maximum load weight of 101.93 kg (225 lbs).

Cleaning

- To clean the product, wipe with a soft, slightly moist cloth.
- If the fabric part is stained, dip a cloth in a diluted neutral detergent, wipe out the stains with it, and fully dry the fabric before use.

CAUTION Do NOT use corrosive detergents or solvents to clean the product.

Maintenance

- Make sure that all the parts and fasteners are tightened once every 1 months.
- Store the product in a dry and shady place away from children and pets.

Specifications

- Net weight: about 18 kg (39.7 lbs)
- Dimensions (W x H x D):
about 630 mm x 1150 mm x 630 mm
(24.8 inch x 45.3 inch x 24.8 inch)



Warranty

The warranty period is 5 years.



EN Images in this manual may look different from the actual product.

FR Les illustrations de ce manuel peuvent varier du produit actuel.

ES Las imágenes de este manual pueden tener un aspecto distinto del producto real.

AR قد تبدو الصور في هذا الدليل مختلفة عن المنتج الفعلي.

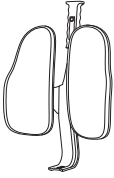

1 (x1)



2 (x1)



3 (x2)



4 (x1)

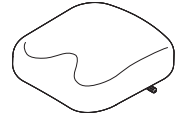

5 (x1)



6 (x1)



7 (x1)

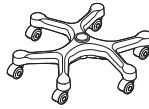

8 (x1)



9 (x1)



10 (x2)



11 (x1)



12 (x1)



13 (x1)

EN Optional **FR** En option **ES** Opcional **AR** اختياري

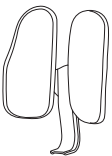

A (x1)

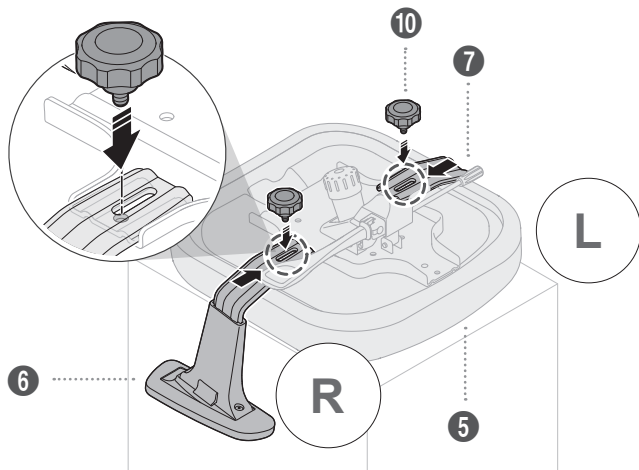

1



5 (x1)



6 (x1)



7 (x1)



10 (x2)

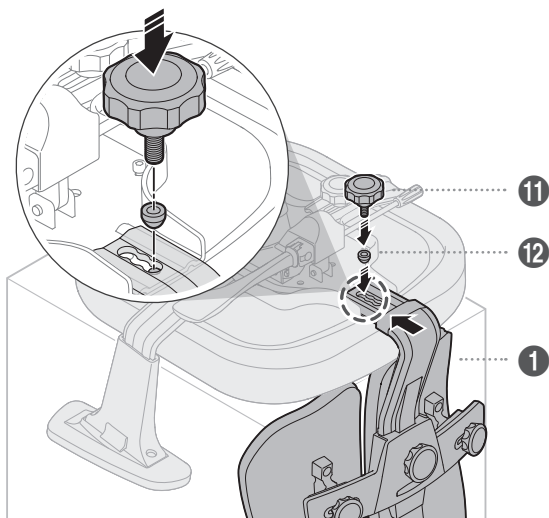

2

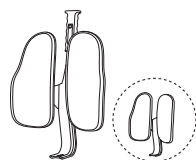

1 / A (x1)



11 (x1)



12 (x1)

EN The shape may differ from the model. **FR** La forme peut varier du modèle illustré.

ES La forma puede ser distinta en función del modelo. **AR** قد يختلف الشكل عن النموذج.

3



9 (x1)

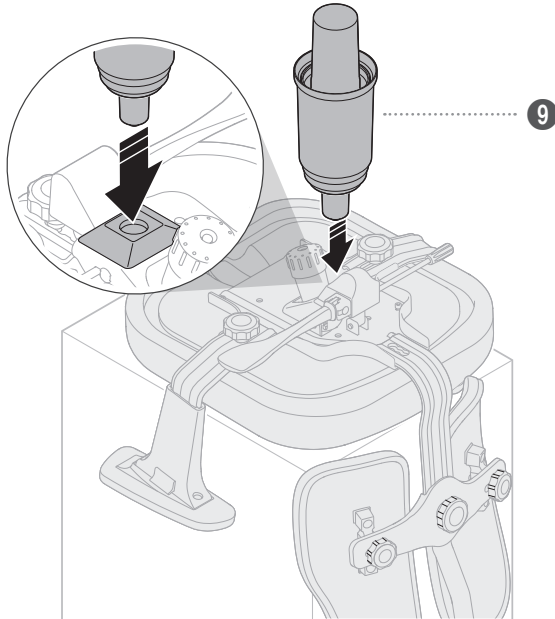
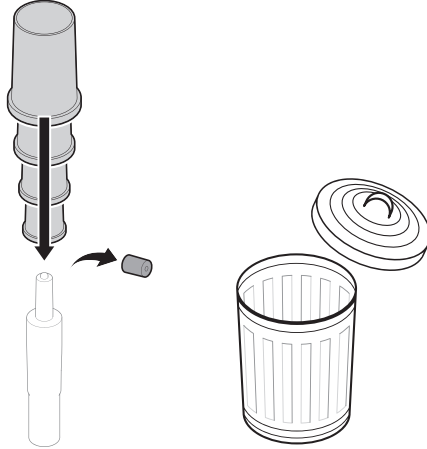

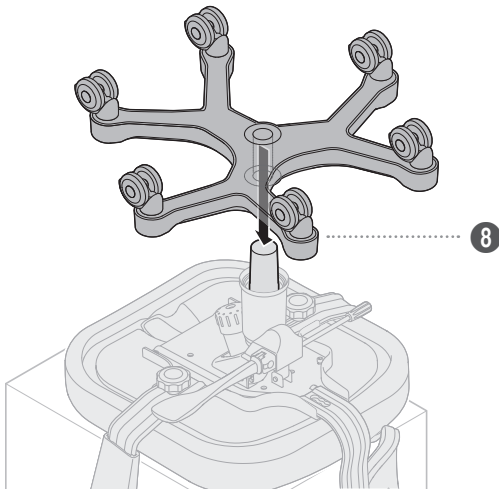

4

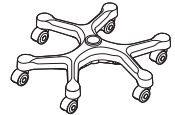

8 (x1)

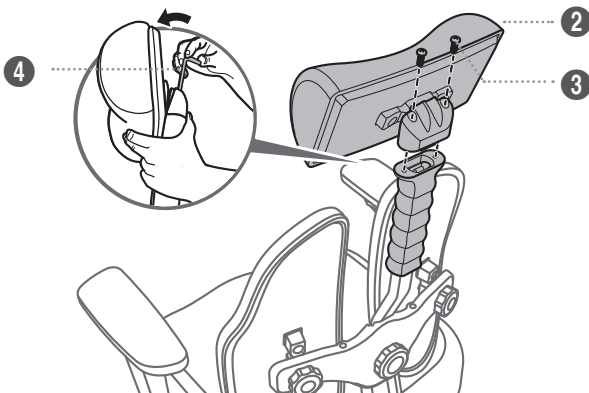

5



2 (x1)



3 (x2)



4 (x1)

6



13 (x1)

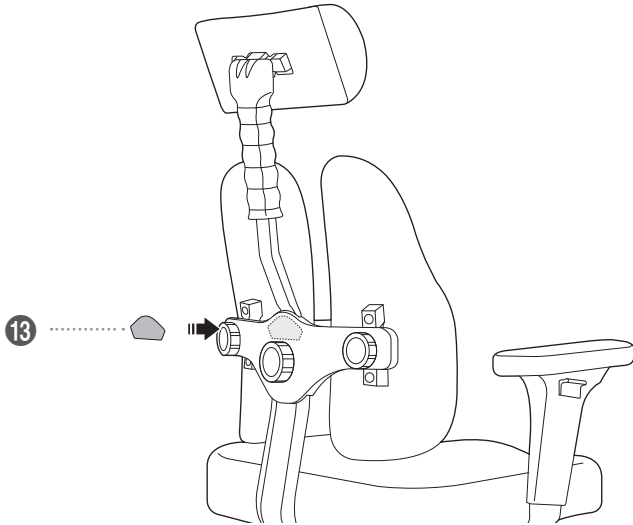

7

EN To adjust seat height

FR Pour ajuster la hauteur du fauteuil

ES Para ajustar la altura del asiento

AR لضبط ارتفاع المقعد

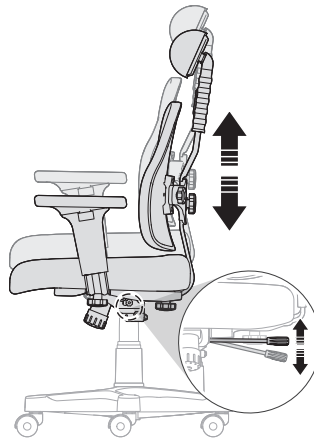

EN To adjust backrest height **FR** Pour ajuster la hauteur du dossier

ES Para ajustar la altura del respaldo

AR لضبط ارتفاع ظهر المقعد

8

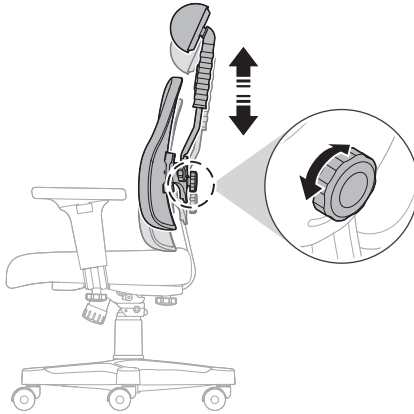

EN To adjust backrest width **FR** Pour ajuster la largeur du dossier

ES Para ajustar la anchura del respaldo

AR لضبط عرض ظهر المقعد

9

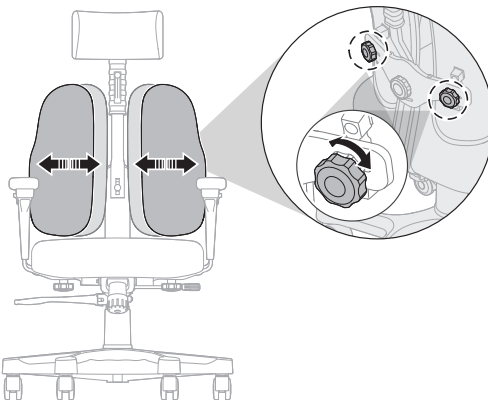

10

EN To adjust backrest tilting strength

FR Pour ajuster la force d'inclinaison du dossier

ES Para ajustar la resistencia de inclinación del respaldo

لضبط قوة إمالة ظهر المقعد **AR**

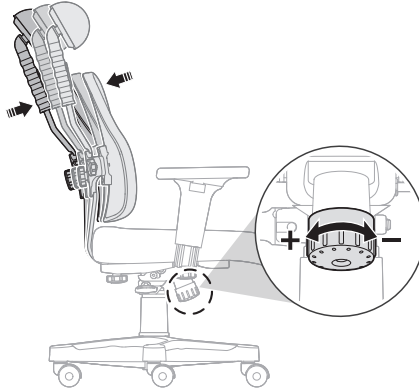

11

EN To fix backrest at desired tilting angle

FR Pour fixer le dossier à l'angle souhaité d'inclinaison

ES Para fijar el respaldo en el ángulo de inclinación deseado

لتثبيت ظهر المقعد بزواياة الإمالة المطلوبة **AR**

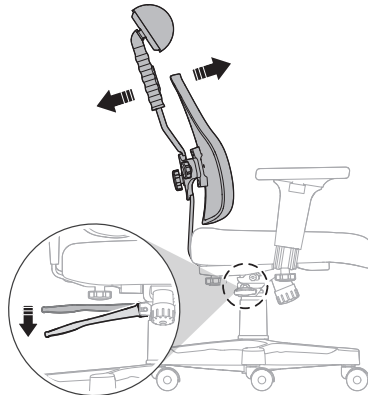

EN To adjust backrest depth **FR** Pour ajuster la profondeur du dossier

ES Para ajustar la profundidad del respaldo

AR لضبط عمق ظهر المقعد

12

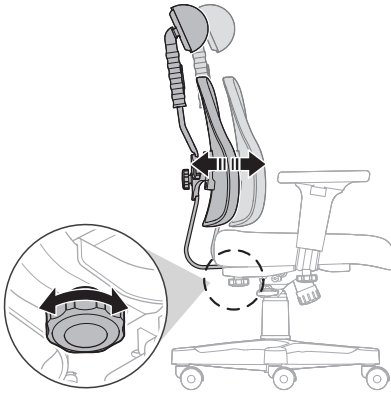

EN To adjust headrest height **FR** Pour ajuster la hauteur du repose-tête

ES Para ajustar la altura del reposacabezas

AR لضبط ارتفاع مسند الرأس

13

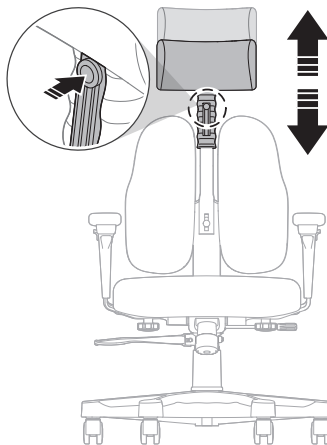

14

EN To adjust armrest height **FR** Pour ajuster la hauteur de l'accoudoir

ES Para ajustar la altura del reposabrazos

AR لضبط ارتفاع مسند الذراع

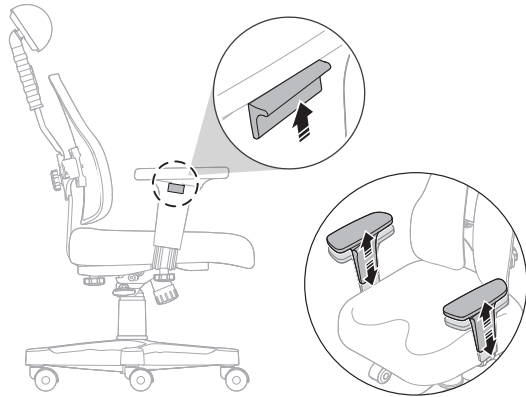

15

EN To adjust armrest width **FR** Pour ajuster la largeur de l'accoudoir

ES Para ajustar la anchura del reposabrazos

AR لضبط عرض مسند الذراع

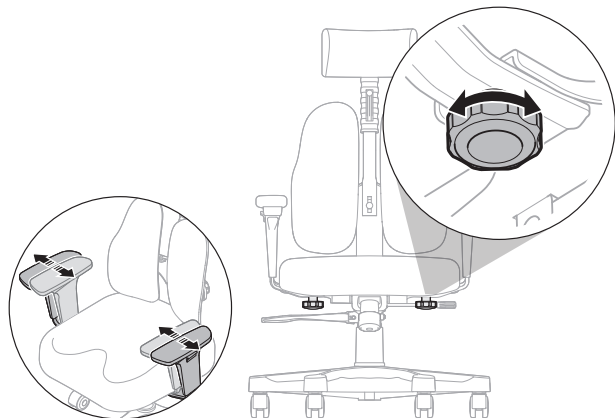



DUOREST
